

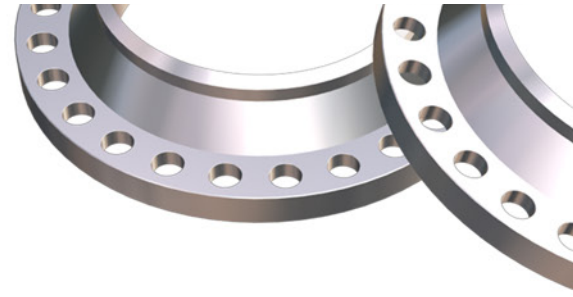

GharbFlange
Since 1979



API FLANGES

- Class 75 Flanges
- Class 150 Flanges
- Class 300 Flanges
- Class 600 Flanges
- Class 900 Flanges

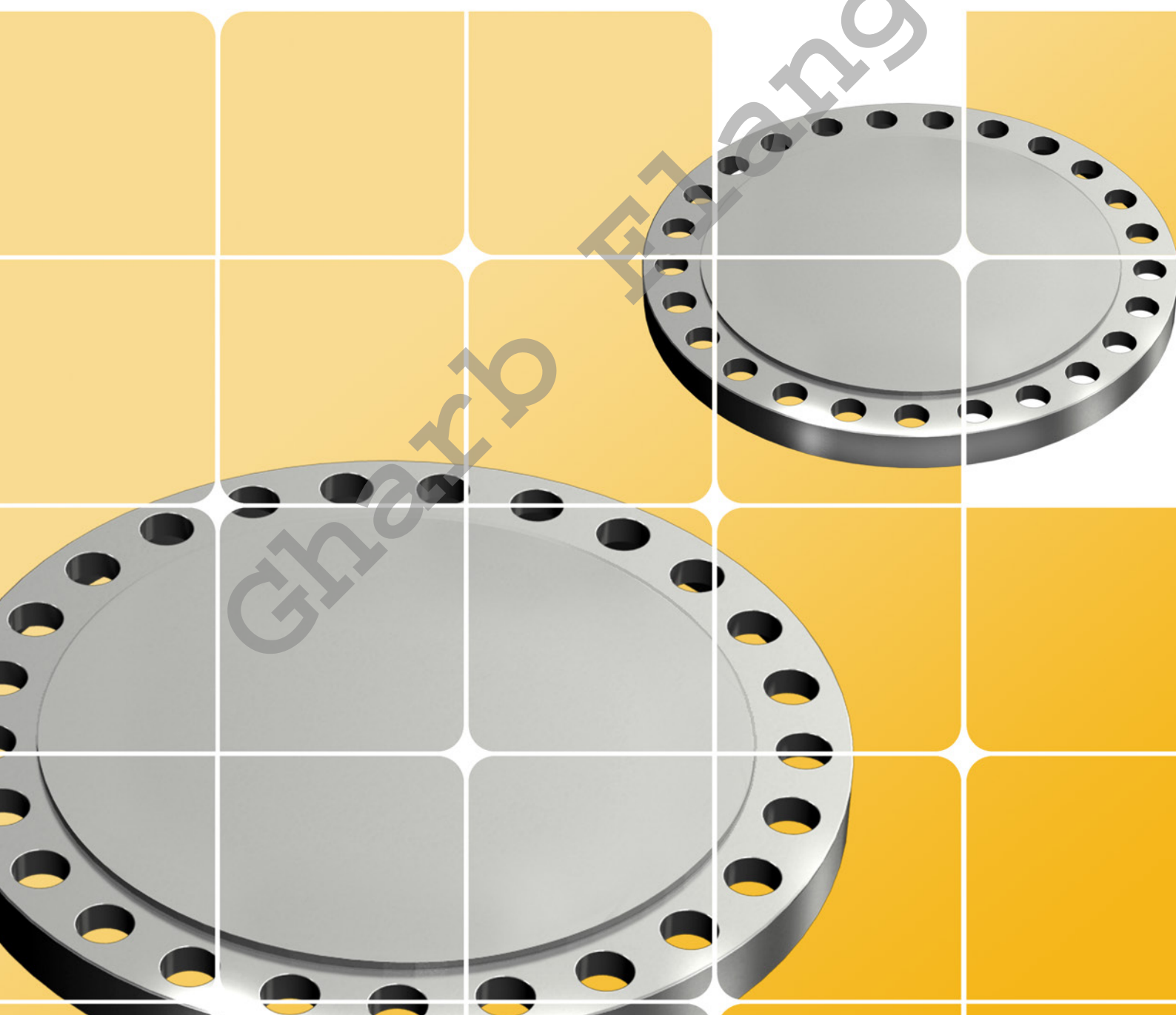



CLASS 75 FLANGES

ASME B 16.47 SERIES B

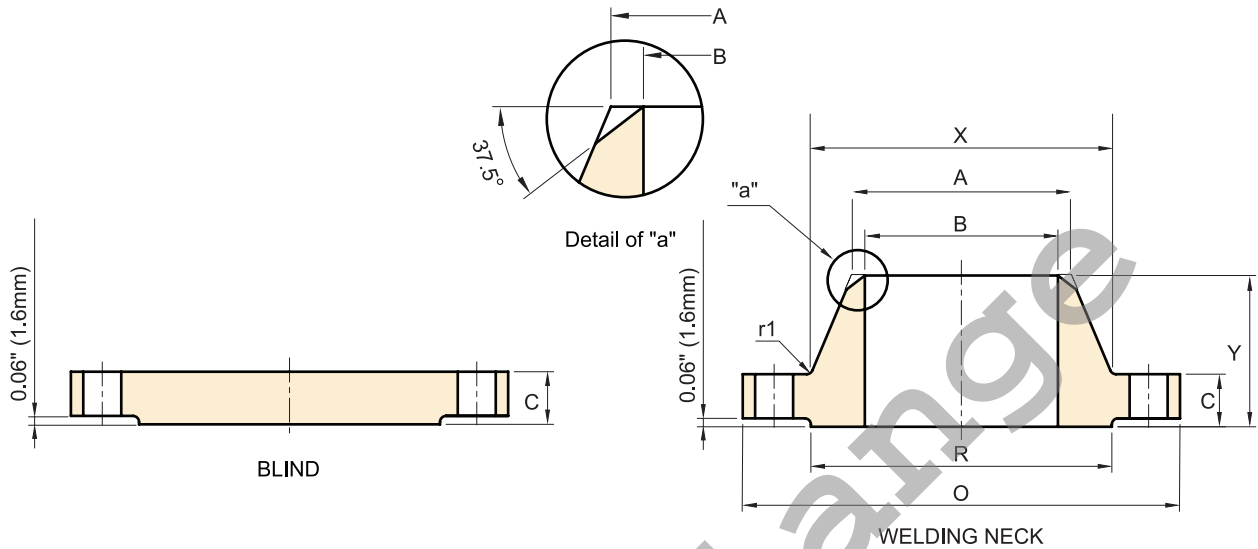

Unit : mm

Nominal Pipe Size	O.D. OF Flange	Thickness		Length Through Hub	Diam. of Hub at Base	Hub Diam. Top	Raised Face Diam.	Drilling			Diam. of Bolt (inch)	Fillet Radius Min.
		W.N.F	Blind					Diam. of Bolt Circle	No. of Bolt Holes	Diam. of Bolt Holes		
		O	C									Y
26	762.0	33.3	33.3	58.7	676.1	661.9	704.9	723.9	36	19.1	5/8	7.9
28	812.8	33.3	33.3	62.0	726.9	712.7	755.7	774.7	40	19.1	5/8	7.9
30	863.6	33.3	33.3	65.0	777.7	763.5	806.5	825.5	44	19.1	5/8	7.9
32	914.4	35.1	36.6	69.9	828.5	814.3	857.3	876.3	48	19.1	5/8	7.9
34	965.2	35.1	38.1	73.2	879.3	865.1	908.1	927.1	52	19.1	5/8	7.9
36	1033.5	36.6	42.4	85.8	935.0	915.9	965.2	992.1	40	22.4	3/4	9.7
38	1084.3	38.1	44.5	88.9	985.8	966.7	1016.0	1042.9	40	22.4	3/4	9.7
40	1135.1	38.1	44.5	91.9	1036.6	1017.5	1066.8	1093.7	44	22.4	3/4	9.7
42	1185.9	39.6	47.8	95.3	1087.4	1068.3	1117.6	1144.5	48	22.4	3/4	9.7
44	1251.0	42.9	49.3	104.6	1140.0	1119.1	1174.8	1203.5	36	25.4	7/8	9.7
46	1301.8	44.5	50.8	108.0	1190.8	1169.9	1225.6	1254.3	40	25.4	7/8	9.7
48	1352.6	46.0	53.8	111.3	1241.6	1220.7	1276.4	1305.1	44	25.4	7/8	9.7
50	1403.4	47.8	55.4	115.8	1293.9	1271.5	1327.2	1355.9	44	25.4	7/8	9.7
52	1457.5	47.8	57.2	120.7	1344.7	1322.3	1378.0	1409.7	48	25.4	7/8	9.7
54	1508.3	49.3	60.5	125.5	1397.0	1373.1	1428.8	1460.5	48	25.4	7/8	9.7
56	1574.8	50.8	62.0	134.9	1450.8	1423.9	1485.9	1521.0	40	28.4	1	11.2
58	1625.6	52.3	63.5	138.2	1501.6	1474.7	1536.7	1571.8	44	28.4	1	11.2
60	1676.4	55.6	66.5	144.5	1552.4	1525.5	1587.5	1622.6	44	28.4	1	11.2

NOTES

- 1) Bore size to be specified by customer.
- 2) When these flanges are required with flat face removed may be furnished.
Users are reminded that removing the raised face will make the length through hub nonstandard.



CLASS 150 FLANGES

ASME B 16.47 SERIES B

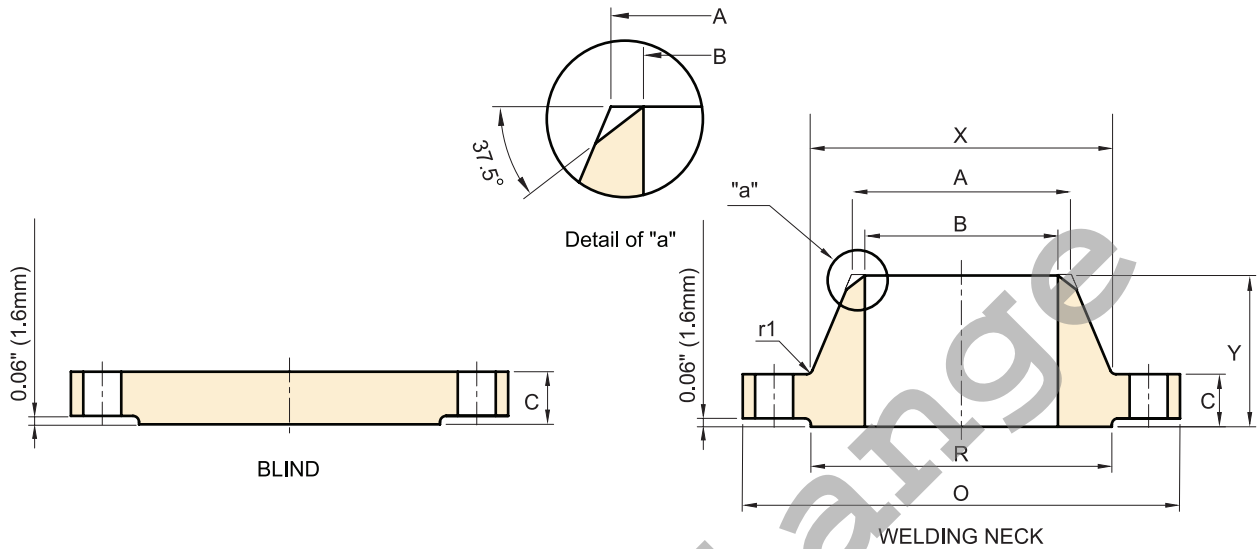

Unit : mm

Nominal Pipe Size	O.D. OF Flange	Thickness		Length Through Hub	Diam. of Hub at Base	Hub Diam. Top	Raised Face Diam.	Drilling			Diam. of Bolt (inch)	Fillet Radius Min.
		W.N.F	Blind					Diam. of Bolt Circle	No. of Bolt Holes	Diam. of Bolt Holes		
		O	C									Y
26	785.9	41.1	44.5	88.9	684.3	661.9	711.2	744.5	36	22.4	3/4	9.7
28	836.7	44.5	47.8	95.3	735.1	712.7	762.0	795.3	40	22.4	3/4	9.7
30	887.5	44.5	50.8	100.1	787.4	763.5	812.8	846.1	44	22.4	3/4	9.7
32	941.3	46.0	53.8	108.0	839.7	814.3	863.6	900.2	48	22.4	3/4	9.7
34	1004.8	49.3	57.2	110.2	892.0	865.1	920.8	957.3	40	25.4	7/8	9.7
36	1057.1	52.3	58.7	117.3	944.6	915.9	971.6	1009.7	44	25.4	7/8	9.7
38	1124.0	53.8	63.5	124.0	997.0	968.2	1022.4	1069.8	40	28.4	1	9.7
40	1174.8	55.6	66.5	128.5	1049.3	1019.0	1079.5	1120.6	44	28.4	1	9.7
42	1225.6	58.7	68.3	133.4	1101.9	1069.8	1130.3	1171.4	48	28.4	1	11.2
44	1276.4	60.5	71.4	136.7	1152.7	1120.6	1181.1	1222.2	52	28.4	1	11.2
46	1341.4	62.0	74.7	144.5	1205.0	1171.4	1234.9	1284.2	40	31.8	1 1/8	11.2
48	1392.2	65.0	77.7	149.4	1257.3	1222.2	1289.1	1335.0	44	31.8	1 1/8	11.2
50	1443.0	68.3	80.8	153.9	1308.1	1273.0	1339.9	1385.8	48	31.8	1 1/8	11.2
52	1493.8	69.9	84.1	157.2	1360.5	1323.8	1390.7	1436.6	52	31.8	1 1/8	11.2
54	1549.4	71.4	87.4	162.1	1412.8	1374.6	1441.5	1492.3	56	31.8	1 1/8	11.2
56	1600.2	73.2	90.4	166.6	1465.4	1425.4	1492.3	1543.1	60	31.8	1 1/8	14.2
58	1674.9	74.7	93.5	174.8	1516.2	1476.2	1543.1	1611.4	48	35.1	1 1/4	14.2
60	1725.9	76.2	96.8	179.3	1570.0	1527.0	1600.2	1662.2	52	35.1	1 1/4	14.2

NOTES

- 1) Bore size to be specified by customer.
- 2) When these flanges are required with flat face removed may be furnished.
Users are reminded that removing the raised face will make the length through hub nonstandard.



CLASS 300 FLANGES

ASME B 16.47 SERIES B

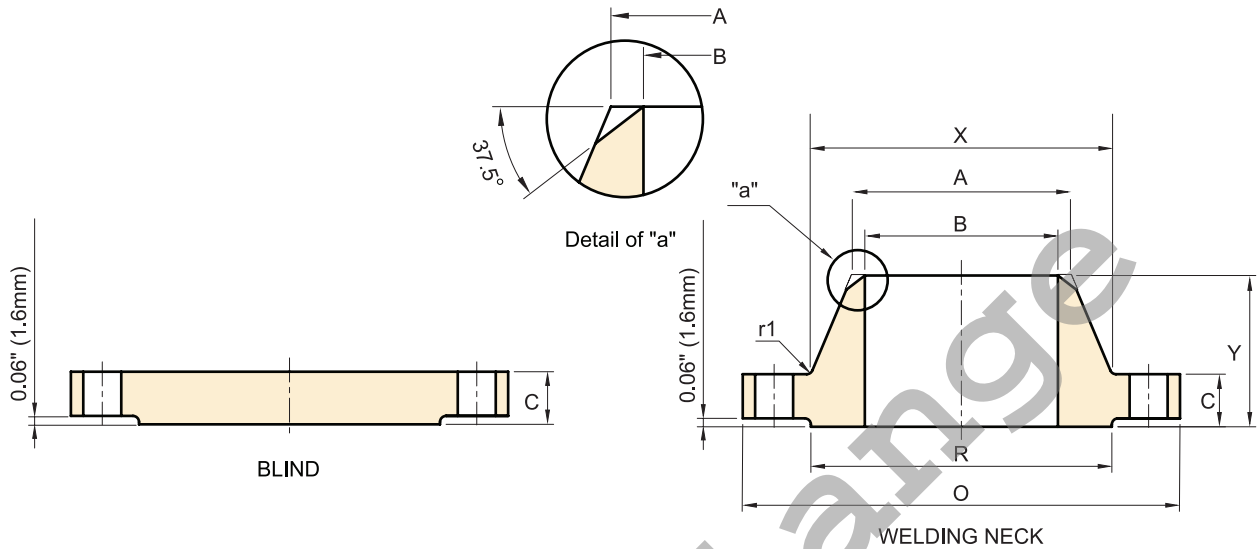

Unit : mm

Nominal Pipe Size	O.D. OF Flange	Thickness		Length Through Hub Y	Diam. of Hub at Base X	Hub Diam. Top A	Raised Face Diam. R	Drilling			Diam. of Bolt (inch)	Fillet Radius Min. r1
		W.N.F	Blind					Diam. of Bolt Circle	No. of Bolt Holes	Diam. of Bolt Holes		
		O	C									C
26	866.6	88.9	88.9	144.5	701.5	665.2	736.6	803.1	32	35.1	1 1/4	14.2
28	920.8	88.9	88.9	149.4	755.7	716.0	787.4	857.3	36	35.1	1 1/4	14.2
30	990.6	93.7	93.7	158.0	812.8	768.4	844.6	920.8	36	38.1	1 3/8	14.2
32	1054.1	103.1	103.1	168.1	863.6	819.2	901.7	977.9	32	41.1	1 1/2	15.7
34	1107.9	103.1	103.1	173.0	917.4	870.0	952.5	1031.7	36	41.1	1 1/2	15.7
36	1171.4	103.1	103.1	180.8	965.2	920.8	1009.7	1089.2	32	44.5	1 5/8	15.7
38	1222.2	111.3	111.3	192.0	1016.0	971.6	1060.5	1140.0	36	44.5	1 5/8	15.7
40	1273.0	115.8	115.8	198.4	1066.8	1022.4	1114.6	1190.8	40	44.5	1 5/8	15.7
42	1333.5	119.1	119.1	204.7	1117.6	1074.7	1168.4	1244.6	36	47.8	1 3/4	15.7
44	1384.3	127.0	127.0	214.4	1173.2	1125.5	1219.2	1295.4	40	47.8	1 3/4	15.7
46	1460.5	128.5	130.0	222.3	1228.9	1176.3	1270.0	1365.3	36	50.8	1 7/8	15.7
48	1511.3	128.5	134.9	223.8	1277.9	1227.1	1327.2	1416.1	40	50.8	1 7/8	15.7
50	1562.1	138.2	139.7	235.0	1330.5	1277.9	1378.0	1466.9	44	50.8	1 7/8	15.7
52	1612.9	142.7	144.3	242.8	1382.8	1328.7	1428.8	1517.7	48	50.8	1 7/8	15.7
54	1673.4	136.7	149.4	239.8	1435.1	1379.5	1479.6	1577.8	48	50.8	1 7/8	15.7
56	1765.3	153.9	157.0	268.2	1493.8	1430.3	1536.7	1651.0	36	60.5	2 1/4	17.5
58	1827.3	153.9	162.1	274.6	1547.9	1481.1	1593.9	1713.0	40	60.5	2 1/4	17.5
60	1878.1	150.9	166.6	271.5	1598.7	1531.9	1651.0	1763.8	40	60.5	2 1/4	17.5

NOTES

- 1) Bore size to be specified by customer.
- 2) When these flanges are required with flat face removed may be furnished.
Users are reminded that removing the raised face will make the length through hub nonstandard.



CLASS 600 FLANGES

ASME B 16.47 SERIES B

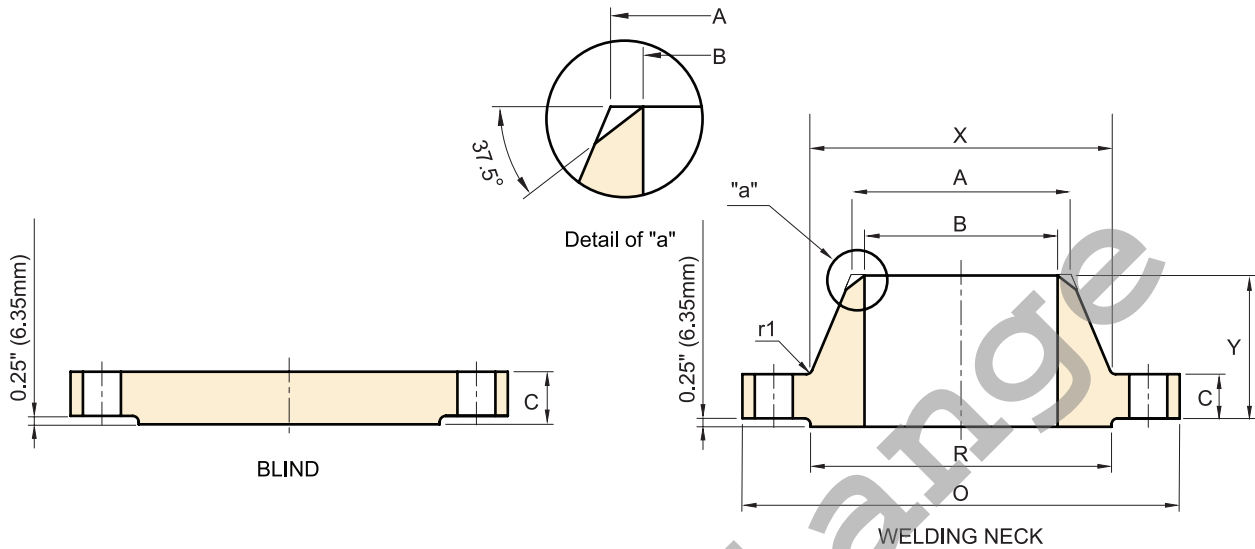

Unit : mm

Nominal Pipe Size	O.D. OF Flange	Thickness		Length Through Hub Y	Diam. of Hub at Base X	Hub Diam. Top A	Raised Face Diam. R	Drilling			Diam. of Bolt (inch)	Fillet Radius Min. r1
		W.N.F	Blind					Diam. of Bolt Circle	No. of Bolt Holes	Diam. of Bolt Holes		
		O	C									C
26	889	111.3	111.3	180.8	698.5	660.4	726.9	806.5	28	44.5	1 5/8	12.7
28	952.5	115.8	115.8	190.5	752.3	711.2	784.4	863.6	28	47.8	1 3/4	12.7
30	1022.4	125.5	127.0	204.7	806.5	762.0	841.2	927.1	28	50.8	1 7/8	12.7
32	1085.9	130.0	134.9	215.9	860.6	812.8	895.4	984.3	28	53.8	2	12.7
34	1162.1	141.2	144.3	233.4	914.4	863.6	952.5	1054.1	24	60.5	2 1/4	14.2
36	1212.9	146.3	150.9	242.8	968.2	914.4	1009.7	1104.9	28	60.5	2 1/4	14.2
38	Size 38" thru 60" are identical to series A, Class 600 flanges.											
40												
42												
44												
46												
48												
50												
52												
54												
56												
58												
60												

NOTES

- 1) Bore size to be specified by customer.
- 2) When these flanges are required with flat face removed may be furnished.
Users are reminded that removing the raised face will make the length through hub nonstandard.



CLASS 900 FLANGES

ASME B 16.47 SERIES B

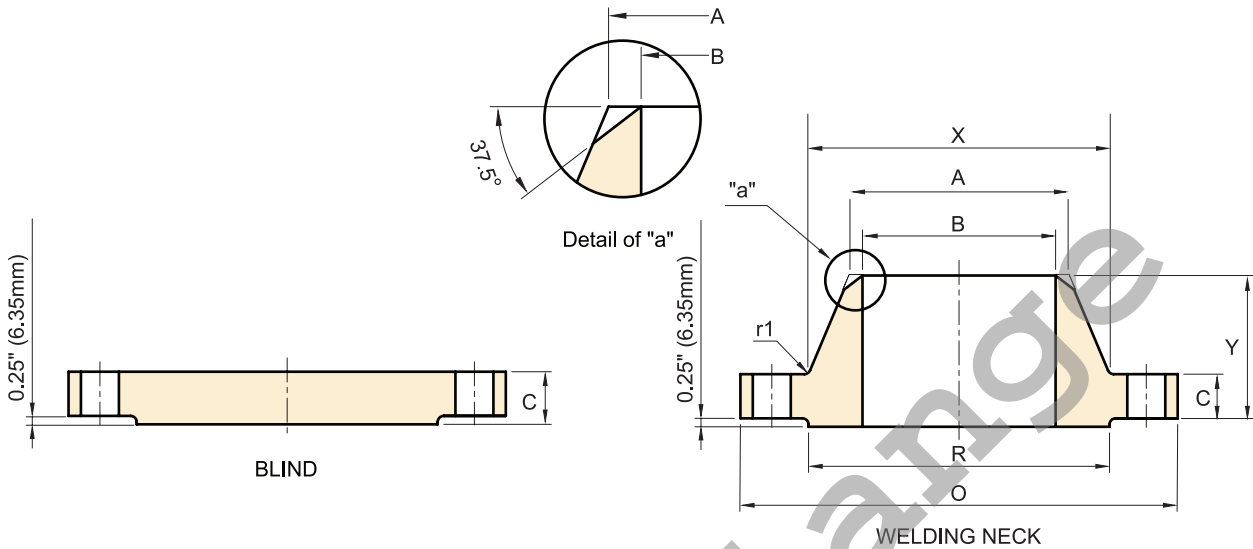

Unit : mm

Nominal Pipe Size	O.D. OF Flange	Thickness		Length Through Hub Y	Diam. of Hub at Base X	Hub Diam. Top A	Raised Face Diam. R	Drilling			Diam. of Bolt (inch)	Fillet Radius Min. r1
		W.N.F	Blind					Diam. of Bolt Circle	No. of Bolt Holes	Diam. of Bolt Holes		
		O	C									C
26	1022.4	134.9	153.9	258.8	743.0	660.4	762.0	901.7	20	66.5	2 1/2	11.2
28	1104.9	147.6	166.6	276.4	797.1	711.2	819.2	971.6	20	73.2	2 3/4	12.7
30	1181.1	155.4	176.0	289.1	850.9	762.0	876.3	1035.1	20	79.2	3	12.7
32	1238.3	160.3	185.7	303.3	908.1	812.8	927.1	1092.2	20	79.2	3	12.7
34	1314.5	171.5	195.1	319.0	962.2	863.6	990.6	1155.7	20	85.9	3 1/4	14.2
36	1346.2	173.0	201.7	325.4	1016.0	914.4	1028.7	1200.2	24	79.2	3	14.2
38	Size 38" thru 60" are identical to series A, Class 900 flanges.											
40												
42												
44												
46												
48												
50												
52												
54												
56												
58												
60												

NOTES

- 1) Bore size to be specified by customer.
- 2) When these flanges are required with flat face removed may be furnished.
Users are reminded that removing the raised face will make the length through hub nonstandard.